

82801 NET-Gateway SIM-Erweiterungsset

Set extension SIM pour passerelle
NET

NET-Gateway estensione per SIM
NET-Gateway SIM extension set

Montageanleitung
Manuel d'utilisation
Istruzione
Manual

MA-10239
V1.3
06.05.2024

Bedienungsanleitung



Manuel d'utilisation



www.Glutz.com



Funktionskontrolle!
Contrôle des fonctions!
Controllo della funzione!
Function check!



SW v1.4.6
FW v2.6.9
oder neuer,
ou plus récent,
o più recente,
or newer

82800 NET-Gateway

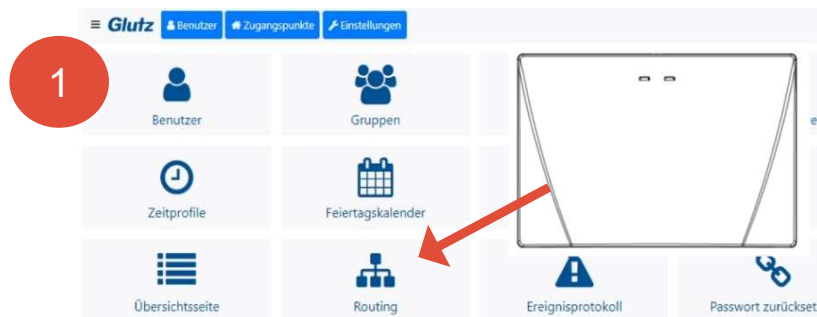

Daten SIM in Mini-Format
Données carte SIM (mini)
Dati della carta SIM (mini)
SIM card - data (mini)

Nicht im Lieferumfang
Non inclus
Non incluso
Not included

Glutz 4G-USB
nur!
seulement !
solo!
only !

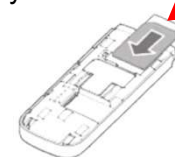

minimum:
Download
0.4 Mbit/s
Upload:
0.2 Mbit/s

4G-USB Dongle & SIM

SIM PIN-Code deaktivieren!
Désactiver PIN de la SIM!
Disattivare il codice PIN della SIM!
Deactivate the PIN!

~~SIM PIN-Code~~



Aufschrauben!
Dévisser!
Svitare!
Unscrew!

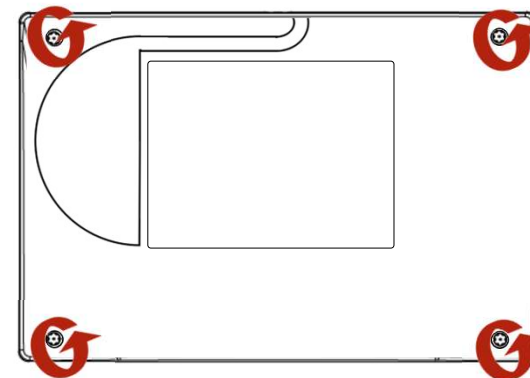
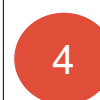

82801 NET-Gateway SIM-Erweiterungsset

Set extension SIM pour passerelle
NET

NET-Gateway estensione per SIM
NET-Gateway SIM extension set

Glutz AG

Segetzstrasse 13 / 4502 Solothurn / CH
Tel. +41 32 625 65 20
info@glutz.com / www.glutz.com

Glutz Deutschland GmbH

Schmalenhofer Strasse 61 / 42551 Velbert / DE
Tel. +49 2051 8013 51-0
info-de@glutz.com / www.glutz.com

Glutz GmbH Österreich

Zimbaggasse 5a / 1140 Wien / AT
Tel. +43 7946 20506
info-at@glutz.com / www.glutz.com

Glutz UK Ltd.

11 Finch Drive, Springwood Industrial Estate / CM7 2SF
Braintree / UK
Tel. +44 1376 348 808
info-uk@glutz.com / www.glutz.com

4G-USB Stick mit den USB-Winkeladaptern in das NET-Gateway montieren!

Monter la clé USB 4G avec les adaptateurs USB dans la passerelle NET!

Montare la chiavetta USB 4G con gli adattatori USB nel NET-Gateway!

Mount the 4G USB stick with the USB adapters in the NET-Gateway!

5

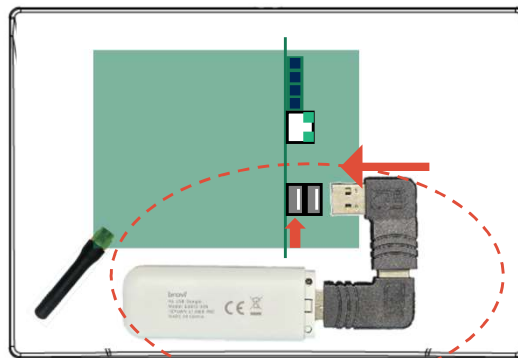

6

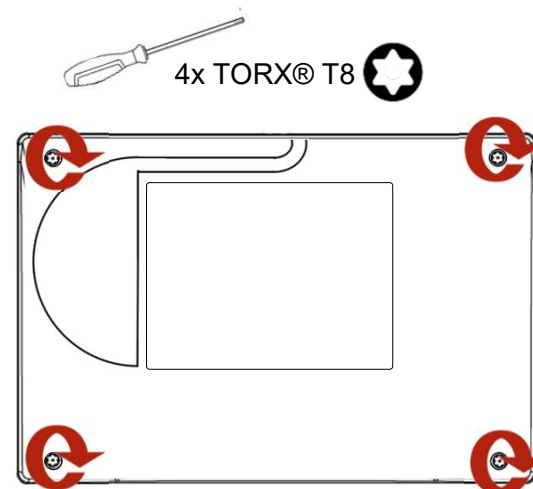

8

eAccess SW (Webclient-Cloud)



An die Stromquelle anschliessen!

Brancher au réseau d'alimentation!

Collegare alla rete di alimentazione!

Connect to the power supply!

7

